

# Conference capacities:

	Ground floor access	Next to garden	A	B	C	D	E	F	G	Area (m <sup>2</sup> )	Ceiling height	Natural daylight
Cedar Suite			500	200	260	70	80	80	350	450	3.5	✓
Rowan Suite			120	80	72	40	40	40	120	200	3.5	✓
Oceans Suite	✓	✓	120	60	66	40	40	40	120	170	3.5	✓
Cypress Suite			120	60	72	30	36	36	140	150	2.9	✓
Oak/Hawthorne			60	25	32	26	30	30	-	96	2.9	✓
Oak Suite			30	24	18	14	14	-	30	48	2.9	✓
Hawthorn Suite			24	12	12	12	14	-	20	48	2.9	✓
Boardroom			40	18	24	18	24	-	-	60	2.8	✓
Willow Suite			-	-	-	14	-	-	-	45	2.5	✓
Sycamore Suite			-	-	-	14	-	-	-	45	2.5	✓
Aspen Suite			30	15	18	15	16	-	-	45	2.5	✓
Maple Suite			-	-	-	-	8	-	-	20	2.5	✓
Laburnum Suite			-	-	-	-	8	-	-	20	2.5	✓
Pine Suite			-	-	-	-	8	-	-	20	2.5	✓
5 Suite Lounges			-	-	-	-	6	-	-	20	2.5	✓

Key:



A



B



C



D



E



F



G

ground floor

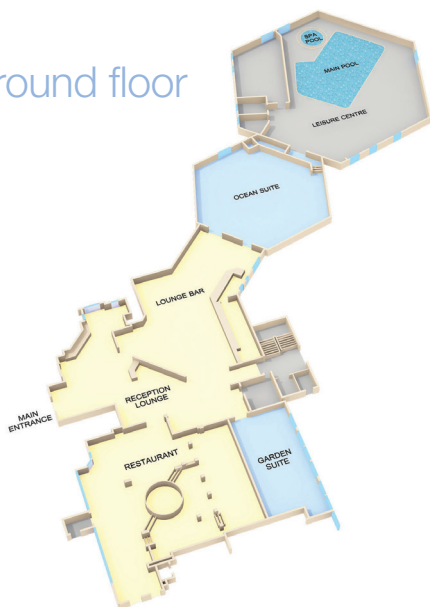

first floor

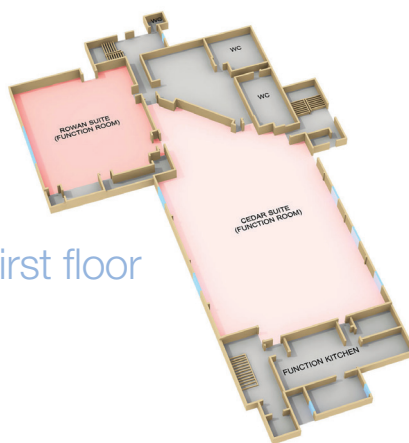

second floor

